

# 5. Approach and Method (June 2nd 2008– July 25th 2008)

## Remove

- Remove temporary facility & existing potables
- Remove construction fence
- New parking and drive way
- New flag pole

FUNCTION	WELLINGTON	
	EXISTING	PROPOSED
Administration	-	4,840
Student Services	-	500
Art	1,188	-
Pre-Kindergarten	-	3,350 (3)
Kindergarten	-	8,720 (8)
Primary	25,082 (23)	-
Intermediate	4,155 (4)	11,240 (12)
Skills	1,060 (1)	1,980 (2)
Custodial	410	1,645
ESE	-	6,250 (4)
Food Service	-	9,670
Music	1,868	-
Media	5,758	-
P.E.	1,800	1,203
Resource	-	2,385 (4)
Stage	-	1,950
Teacher Planning	2,063	1,000
Restrooms	563	1,463
TOTAL NET	43,807	56,507
TOTAL GROSS		76,583

) = Denotes Number of Classrooms

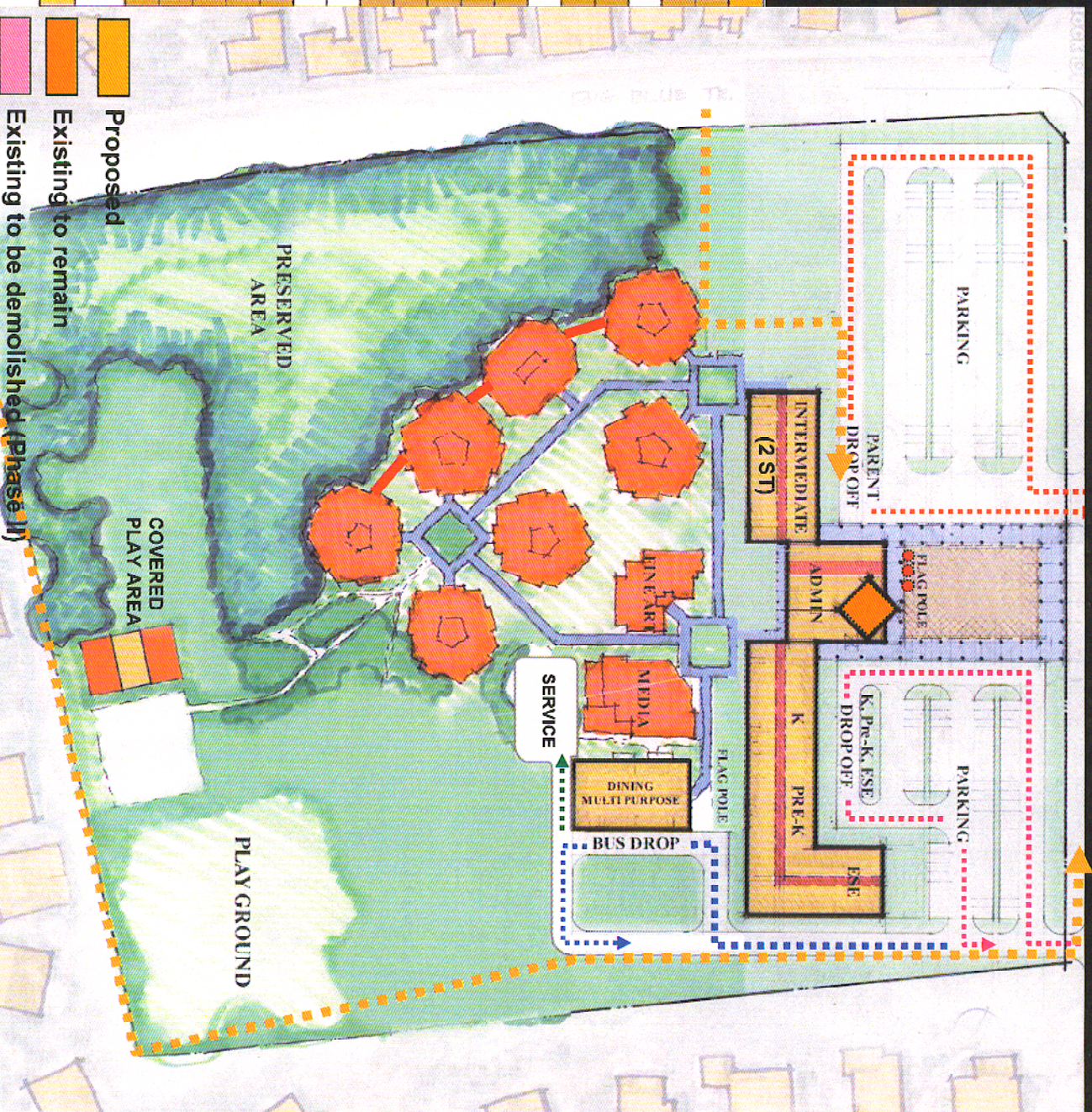

- Proposed
- Existing to remain
- Existing to be demolished (Phase II)